

© CROWN COPYRIGHT AND DATABASE RIGHTS 2022  
ALL RIGHTS RESERVED. HCC 100019180

REV	AMENDMENTS	DATE	CAD	CHKD	APPD



**Hampshire  
County Council**

STUART JARVIS BSc DipTP FCIHT MRPTI: DIRECTOR OF ECONOMY,  
TRANSPORT & ENVIRONMENT

DESIGNER NB	SCHEME  TWYFORD	DRAWING TITLE  LOCATION PLAN	
CAD LH		JOB No.	DATE OCT 22
CHECKED NB	SCALE @ A3 NTS	SHEET NUMBER	DRAWING NUMBER SE/NB/000
APPROVED			REV

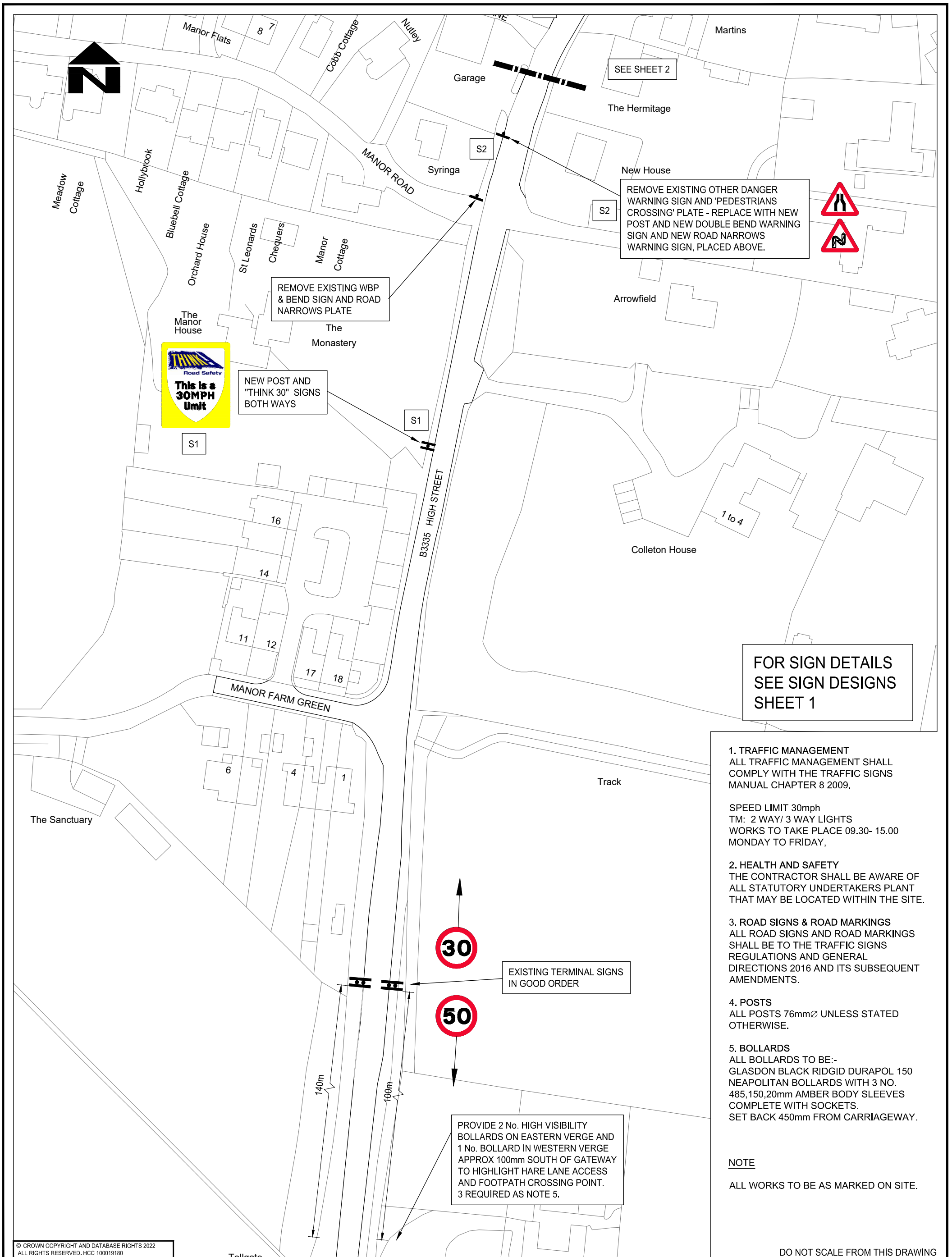

1. TRAFFIC MANAGEMENT  
ALL TRAFFIC MANAGEMENT SHALL COMPLY WITH THE TRAFFIC SIGNS MANUAL CHAPTER 8 2009.  
  
SPEED LIMIT 30mph  
TM: 2 WAY/ 3 WAY LIGHTS  
WORKS TO TAKE PLACE 09.30- 15.00  
MONDAY TO FRIDAY,
  2. HEALTH AND SAFETY  
THE CONTRACTOR SHALL BE AWARE OF ALL STATUTORY UNDERTAKERS PLANT THAT MAY BE LOCATED WITHIN THE SITE.
  3. ROAD SIGNS & ROAD MARKINGS  
ALL ROAD SIGNS AND ROAD MARKINGS SHALL BE TO THE TRAFFIC SIGNS REGULATIONS AND GENERAL DIRECTIONS 2016 AND ITS SUBSEQUENT AMENDMENTS.
  4. POSTS  
ALL POSTS 76mmØ UNLESS STATED OTHERWISE.
  5. BOLLARDS  
ALL BOLLARDS TO BE:-  
GLASDON BLACK RIDGID DURAPOL 150 NEAPOLITAN BOLLARDS WITH 3 NO. 485, 150,20mm AMBER BODY SLEEVES COMPLETE WITH SOCKETS.  
SET BACK 450mm FROM CARRIAGEWAY.
- NOTE**  
ALL WORKS TO BE AS MARKED ON SITE.

© CROWN COPYRIGHT AND DATABASE RIGHTS 2022  
ALL RIGHTS RESERVED. HCC 100019180

DO NOT SCALE FROM THIS DRAWING

<p><b>Hampshire County Council</b> STUART JARVIS BSc DipTP FCIHT MRTPI, DIRECTOR OF ECONOMY, TRANSPORT &amp; ENVIRONMENT</p>				DESIGNER NB	SCHEME Twyford	DRAWING TITLE SIGNING & LINING PROPOSALS					
				CAD LH		HCC CAD PLT: 30/11/2022 13:18:08					
REV	AMENDMENTS	DATE	CAD	CHKD	APPD	APPROVED	SCALE @ A3 1:1000	DATE Oct-22	SHEET NUMBER 1 OF 6	DRAWING NUMBER SE/NB/001	REV

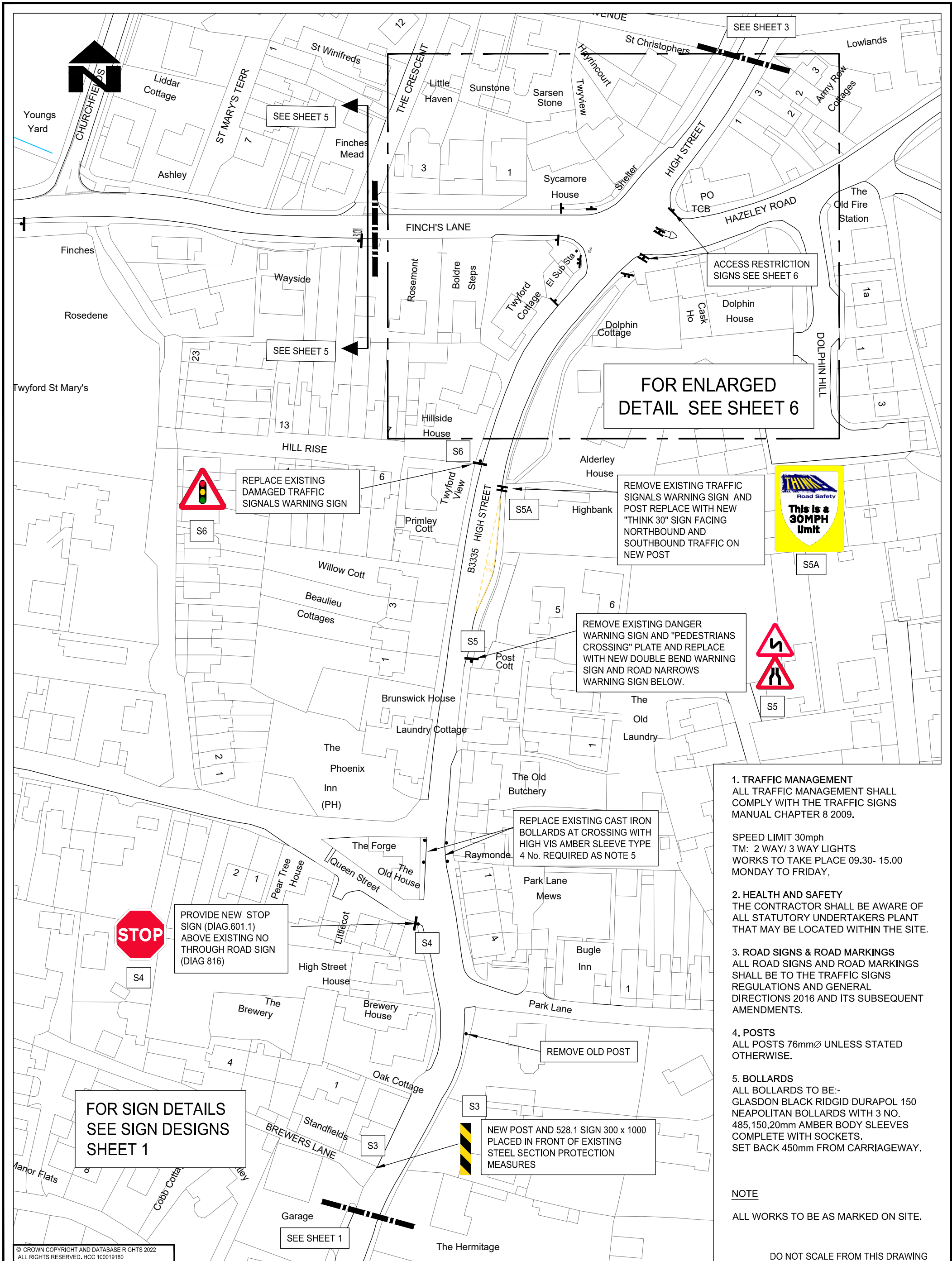

1. TRAFFIC MANAGEMENT  
ALL TRAFFIC MANAGEMENT SHALL COMPLY WITH THE TRAFFIC SIGNS MANUAL CHAPTER 8 2009.  
  
SPEED LIMIT 30mph  
TM: 2 WAY/ 3 WAY LIGHTS  
WORKS TO TAKE PLACE 09.30- 15.00  
MONDAY TO FRIDAY,
  2. HEALTH AND SAFETY  
THE CONTRACTOR SHALL BE AWARE OF ALL STATUTORY UNDERTAKERS PLANT THAT MAY BE LOCATED WITHIN THE SITE.
  3. ROAD SIGNS & ROAD MARKINGS  
ALL ROAD SIGNS AND ROAD MARKINGS SHALL BE TO THE TRAFFIC SIGNS REGULATIONS AND GENERAL DIRECTIONS 2016 AND ITS SUBSEQUENT AMENDMENTS.
  4. POSTS  
ALL POSTS 76mmØ UNLESS STATED OTHERWISE.
  5. BOLLARDS  
ALL BOLLARDS TO BE:-  
GLASDON BLACK RIDGID DURAPOL 150 NEAPOLITAN BOLLARDS WITH 3 NO. 485,150,20mm AMBER BODY SLEEVES COMPLETE WITH SOCKETS.  
SET BACK 450mm FROM CARRIAGEWAY.
- NOTE**  
ALL WORKS TO BE AS MARKED ON SITE.

DO NOT SCALE FROM THIS DRAWING

<p><b>Hampshire County Council</b> STUART JARVIS BSc DipTP FCIHT MRTPI, DIRECTOR OF ECONOMY, TRANSPORT &amp; ENVIRONMENT</p>		DESIGNER	SCHEME		DRAWING TITLE	
		NB	TWYFORD		SIGNING PROPOSALS	
REV		CAD	APPROVED	JOB No.	DATE	SHEET NUMBER
AMENDMENTS		LH		SCALE @ A3	Oct-22	2 OF 6
DATE		CHKD		1:1000		DRAWING NUMBER
APPD						SE/NB/002
						REV

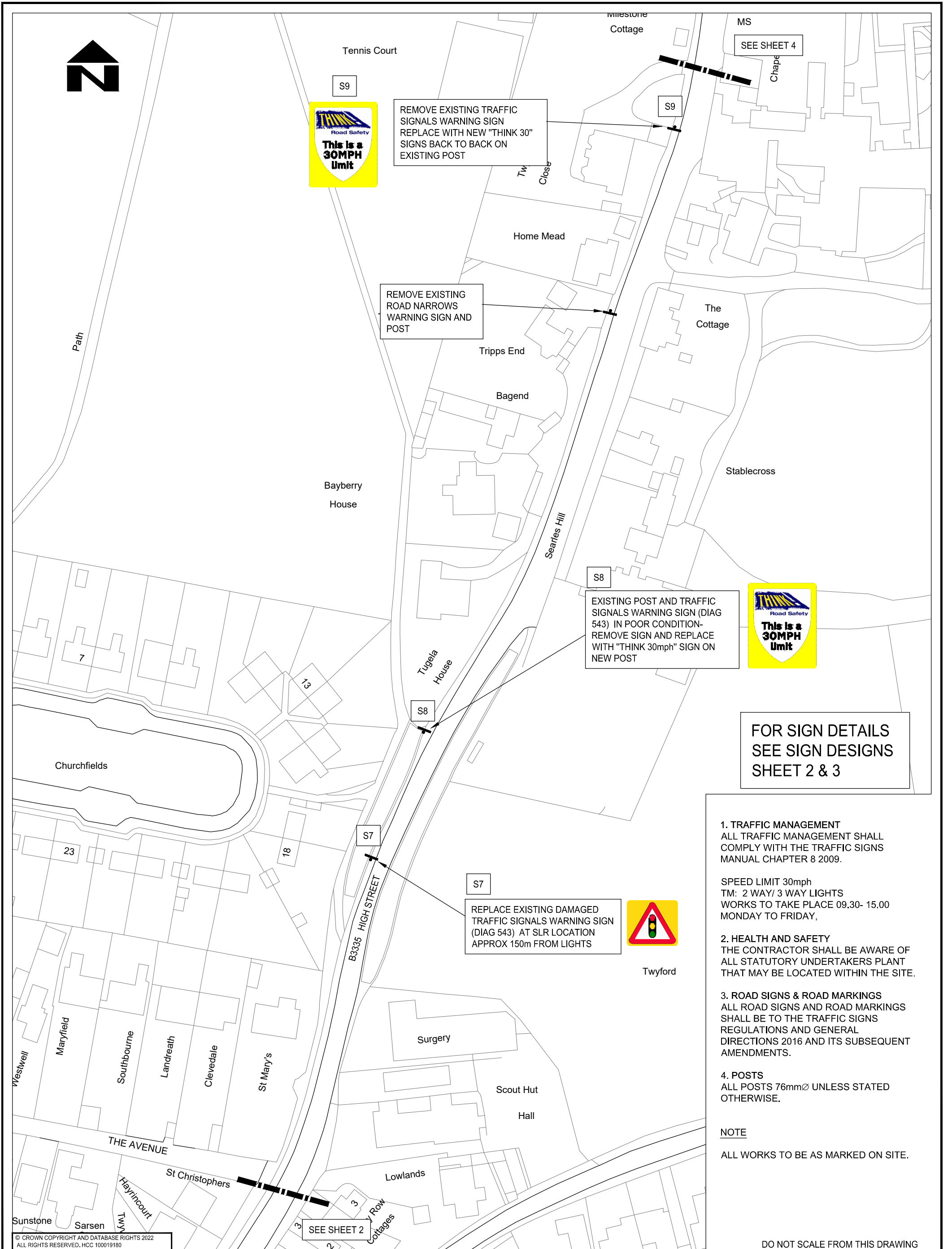

REMOVE EXISTING TRAFFIC SIGNALS WARNING SIGN  
REPLACE WITH NEW "THINK 30"  
SIGNS BACK TO BACK ON EXISTING POST

REMOVE EXISTING ROAD NARROWS WARNING SIGN AND POST

EXISTING POST AND TRAFFIC SIGNALS WARNING SIGN (DIAG 543) IN POOR CONDITION- REMOVE SIGN AND REPLACE WITH "THINK 30mph" SIGN ON NEW POST

REPLACE EXISTING DAMAGED TRAFFIC SIGNALS WARNING SIGN (DIAG 543) AT SLR LOCATION APPROX 150m FROM LIGHTS



Twyford

FOR SIGN DETAILS SEE SIGN DESIGNS SHEET 2 & 3

1. TRAFFIC MANAGEMENT  
ALL TRAFFIC MANAGEMENT SHALL COMPLY WITH THE TRAFFIC SIGNS MANUAL CHAPTER 8 2009.

SPEED LIMIT 30mph  
TM: 2 WAY/ 3 WAY LIGHTS  
WORKS TO TAKE PLACE 09.30- 15.00 MONDAY TO FRIDAY,

2. HEALTH AND SAFETY  
THE CONTRACTOR SHALL BE AWARE OF ALL STATUTORY UNDERTAKERS PLANT THAT MAY BE LOCATED WITHIN THE SITE.

3. ROAD SIGNS & ROAD MARKINGS  
ALL ROAD SIGNS AND ROAD MARKINGS SHALL BE TO THE TRAFFIC SIGNS REGULATIONS AND GENERAL DIRECTIONS 2016 AND ITS SUBSEQUENT AMENDMENTS.

4. POSTS  
ALL POSTS 76mmØ UNLESS STATED OTHERWISE.

NOTE  
ALL WORKS TO BE AS MARKED ON SITE.

DO NOT SCALE FROM THIS DRAWING

© CROWN COPYRIGHT AND DATABASE RIGHTS 2022  
ALL RIGHTS RESERVED. HCC 100019180

<p><b>Hampshire County Council</b> STUART JARVIS BSc DipTP FCIHT MRTPI DIRECTOR OF ECONOMY, TRANSPORT &amp; ENVIRONMENT</p>				DESIGNER	SCHEME		DRAWING TITLE	
				NB	TWYFORD		SIGNING PROPOSALS	
				CAD				
				LH				
				CHECKED				
				APPROVED	SCALE @ A3	DATE	SHEET NUMBER	REV
					1:1000	Oct-22	3 OF 6	
				HCC CAD PLOT: 30/11/2022 13:18:18		DRAWING NUMBER		
				SE/NB/003				

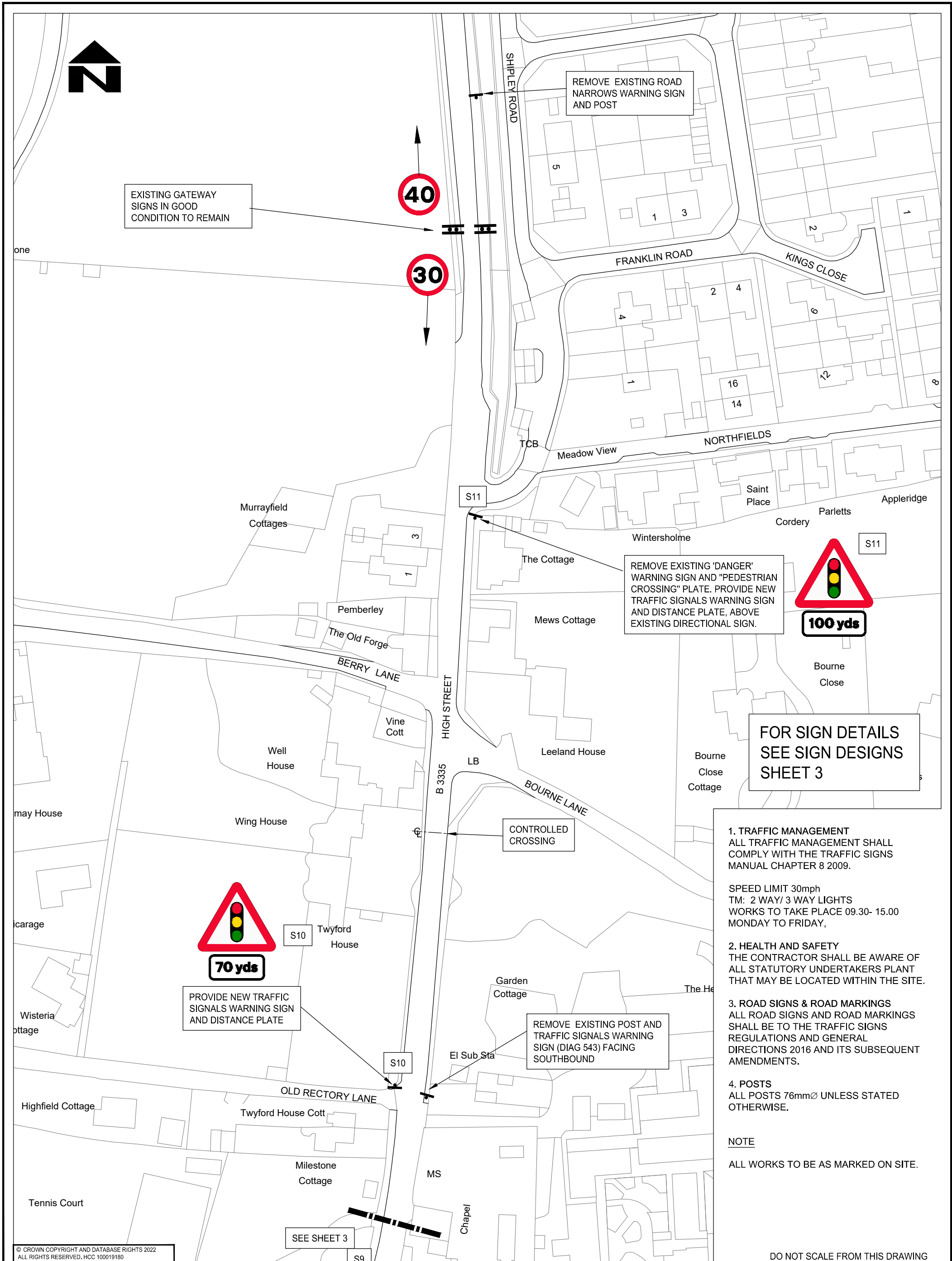

**FOR SIGN DETAILS  
SEE SIGN DESIGNS  
SHEET 3**

- 1. TRAFFIC MANAGEMENT**  
ALL TRAFFIC MANAGEMENT SHALL COMPLY WITH THE TRAFFIC SIGNS MANUAL CHAPTER 8 2009.  
  
SPEED LIMIT 30mph  
TM: 2 WAY/ 3 WAY LIGHTS  
WORKS TO TAKE PLACE 09.30- 15.00  
MONDAY TO FRIDAY,
  - 2. HEALTH AND SAFETY**  
THE CONTRACTOR SHALL BE AWARE OF ALL STATUTORY UNDERTAKERS PLANT THAT MAY BE LOCATED WITHIN THE SITE.
  - 3. ROAD SIGNS & ROAD MARKINGS**  
ALL ROAD SIGNS AND ROAD MARKINGS SHALL BE TO THE TRAFFIC SIGNS REGULATIONS AND GENERAL DIRECTIONS 2016 AND ITS SUBSEQUENT AMENDMENTS.
  - 4. POSTS**  
ALL POSTS 76mmØ UNLESS STATED OTHERWISE.
- NOTE**  
ALL WORKS TO BE AS MARKED ON SITE.

DO NOT SCALE FROM THIS DRAWING

<p><b>Hampshire County Council</b> STUART JARVIS BSc DipTP FCIHT MRTPI, DIRECTOR OF ECONOMY, TRANSPORT &amp; ENVIRONMENT</p>		DESIGNER	SCHEME		DRAWING TITLE	
		NB	TWYFORD		SIGNING PROPOSALS	
REV		CAD	CHECKED	JOB No.	DATE	SHEET NUMBER
AMENDMENTS		LH		SCALE @ A3	OCT 22	4 OF 6
DATE		APPROVED		1:1000		DRAWING NUMBER
CAD	CHKD					SE/NB/004
APPD						REV



PROVIDE 2 No. NEW SOCKETS AND POSTS FOR SPEED INDICATOR INSTALLATIONS ON SHAWFORD ROAD IN EASTERN VERGE LOCATION TO BE AGREED

REMOVE POST AND EXISTING ROAD NARROWS AND PEDESTRIANS IN ROAD WARNING SIGNS AND "NO FOOTWAY FOR 400yds" PLATE, TOGETHER WITH CYCLEWAY SIGNAGE REPLACE WITH NEW EQUIVALENT SIGNING WITH YELLOW BACKING ON NEW POST



REMOVE EXISTING POST AND ROAD NARROWS AND PEDESTRIANS IN ROAD WARNING SIGNS AND "NO FOOTWAY FOR 400yds" PLATE. REPLACE WITH NEW EQUIVALENT SIGNING WITH YELLOW BACKING. ON NEW POST.



UPGRADE EXISTING SCHOOL WARNING SIGN & PLATE TO 600mm HIGH ON A YELLOW BACKING ON NEW POST



REMOVE EXISTING CYCLEWAY SIGN AND POST



REPLACE EXISTING SCHOOL SIGN WITH NEW 600mm HIGH YELLOW BACKED SIGN ON EXISTING POST

FOR SIGN DETAILS SEE SIGN DESIGNS SHEET 3

- 1. TRAFFIC MANAGEMENT**  
ALL TRAFFIC MANAGEMENT SHALL COMPLY WITH THE TRAFFIC SIGNS MANUAL CHAPTER 8 2009.  
  
SPEED LIMIT 30mph  
TM: 2 WAY/ 3 WAY LIGHTS  
WORKS TO TAKE PLACE 09.30- 15.00  
MONDAY TO FRIDAY,
  - 2. HEALTH AND SAFETY**  
THE CONTRACTOR SHALL BE AWARE OF ALL STATUTORY UNDERTAKERS PLANT THAT MAY BE LOCATED WITHIN THE SITE.
  - 3. ROAD SIGNS & ROAD MARKINGS**  
ALL ROAD SIGNS AND ROAD MARKINGS SHALL BE TO THE TRAFFIC SIGNS REGULATIONS AND GENERAL DIRECTIONS 2016 AND ITS SUBSEQUENT AMENDMENTS.
  - 4. POSTS**  
ALL POSTS 76mmØ UNLESS STATED OTHERWISE.
- NOTE**  
ALL WORKS TO BE AS MARKED ON SITE.

© CROWN COPYRIGHT AND DATABASE RIGHTS 2022  
ALL RIGHTS RESERVED. HCC 100019180

DO NOT SCALE FROM THIS DRAWING



STUART JARVIS BSc DipTP FCIHT MRTPI: DIRECTOR OF ECONOMY, TRANSPORT & ENVIRONMENT

DESIGNER NB	SCHEME TWYFORD	DRAWING TITLE SIGNING PROPOSALS	
CAD LH		HCC CAD PLOT: 30/11/2022 13:18:28	REV
CHECKED NB	JOB No.	DATE OCT 22	SHEET NUMBER 5 OF 6
APPROVED	SCALE @ A3 NTS	DRAWING NUMBER SE/NB/005	

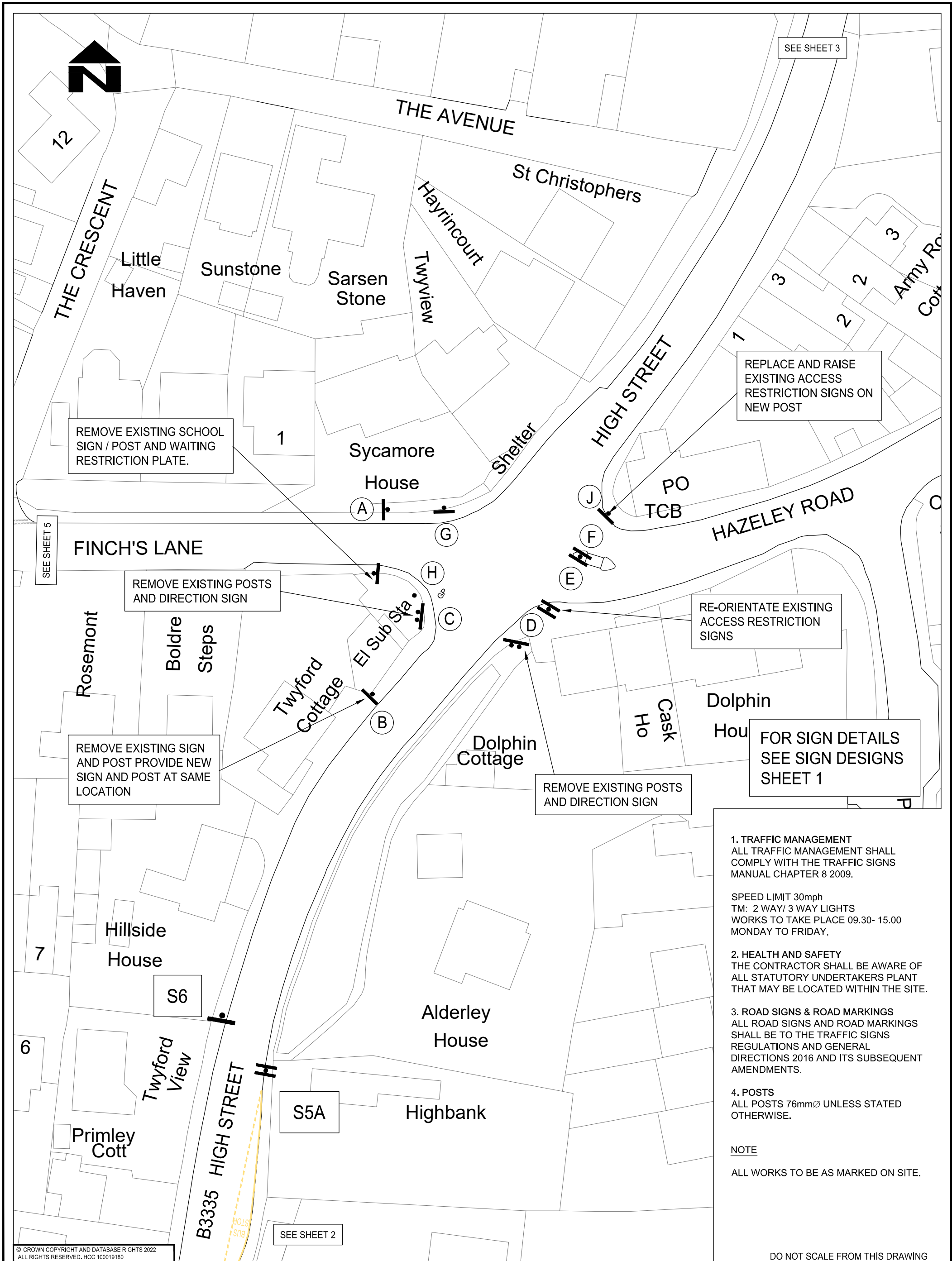

© CROWN COPYRIGHT AND DATABASE RIGHTS 2022  
 ALL RIGHTS RESERVED. HCC 100019180

DO NOT SCALE FROM THIS DRAWING

<p><b>Hampshire County Council</b>  <small>STUART JARVIS BSc DipTP FCIHT MRTPI, DIRECTOR OF ECONOMY, TRANSPORT &amp; ENVIRONMENT</small></p>			DESIGNER <b>NB</b>	SCHEME <b>TWYFORD</b>		DRAWING TITLE <b>SIGNING PROPOSALS</b>		
CAD <b>LH</b>			JOB No. <small>SCALE @ A3</small> <b>1:500</b>		DATE <b>Oct-22</b>	SHEET NUMBER <b>6 OF 6</b>	DRAWING NUMBER <b>SE/NB/006</b>	
CHECKED 			APPROVED 		HCC CAD PL. OF: 30/11/2022 13:18:33 <small>REV</small>			
DATE 								

- NOTES**
1. ALL ROAD SIGNS SHALL BE TO THE TRAFFIC SIGNS REGULATIONS AND GENERAL DIRECTIONS 2016 AND ALL SUBSEQUENT AMENDMENTS.
  2. ALL DIMENSIONS IN MILLIMETERS UNLESS STATED OTHERWISE.
  3. ALL POSTS TO BE 76mmØ UNLESS STATED OTHERWISE

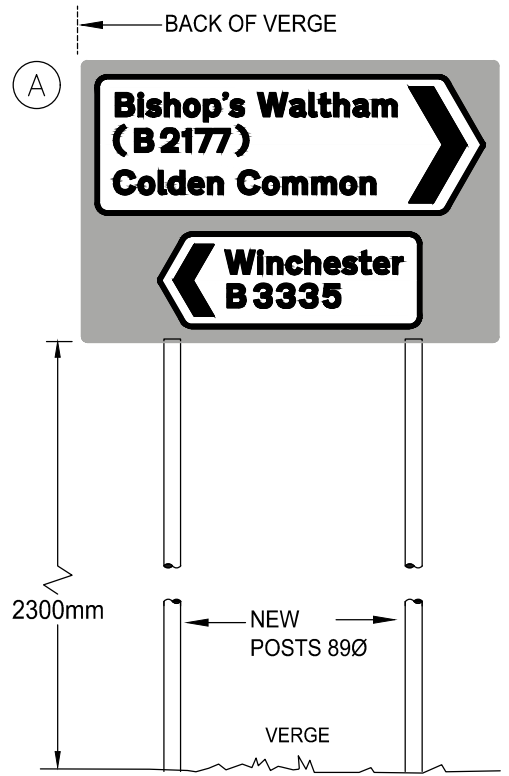

Scheme Ref. Twyford		
Sign Reference	A-	'x'-height 62.5
Letter colour	N/A	SIGN FACE
Background	GREY	Width 1551mm
Border	N/A	Height 1045mm
Material	Class RA2 (12899-1:2007)	Area 1.62m <sup>2</sup>

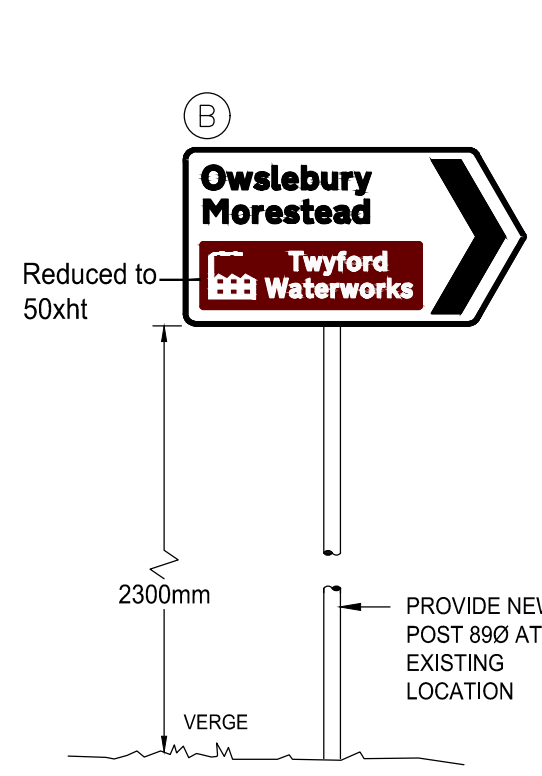

Scheme Ref. Twyford		
Sign Ref.	Sign B	x-height 62.5
Letter colour	BLACK	SIGN FACE
Background	WHITE	Width 1280 mm
Border	BLACK	Height 665 mm
Material	Class RA2 (12899-1:2007)	Area 0.85 m <sup>2</sup>

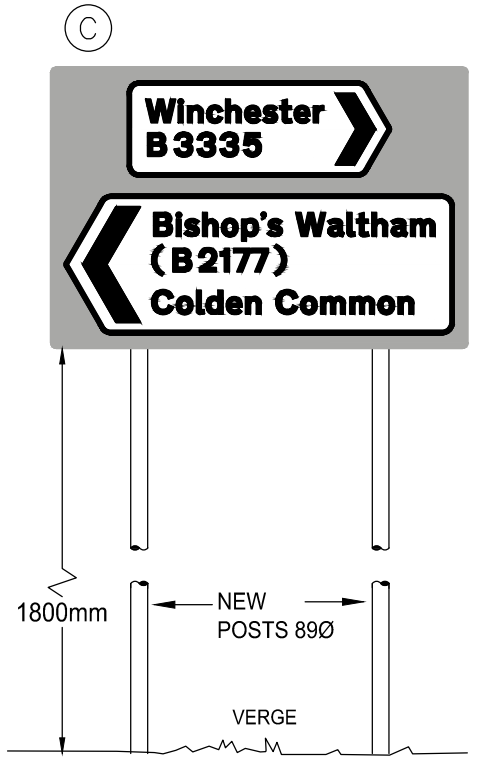

Scheme Ref. Twyford		
Sign Reference	C-	'x'-height 62.5
Letter colour	N/A	SIGN FACE
Background	GREY	Width 1551mm
Border	N/A	Height 1045mm
Material	Class RA2 (12899-1:2007)	Area 1.62m <sup>2</sup>

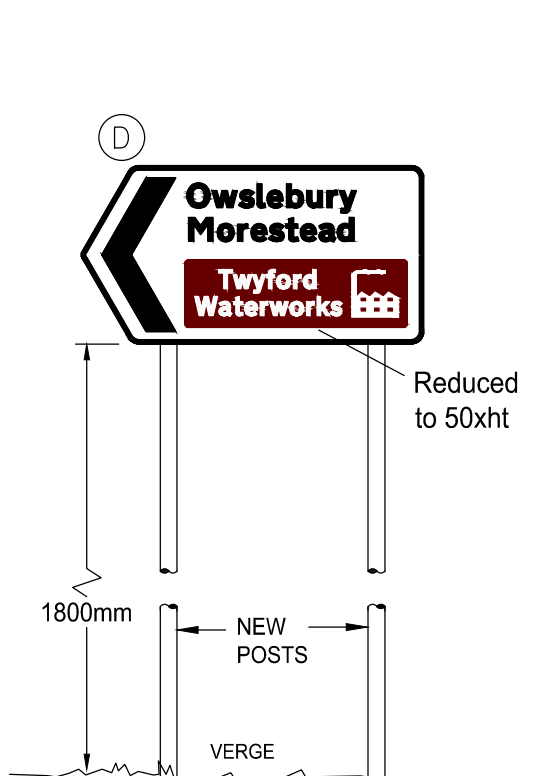

Scheme Ref. Twyford		
Sign Ref.	Sign D	x-height 62.5
Letter colour	BLACK	SIGN FACE
Background	WHITE	Width 1280 mm
Border	BLACK	Height 665 mm
Material	Class RA2 (12899-1:2007)	Area 0.85 m <sup>2</sup>

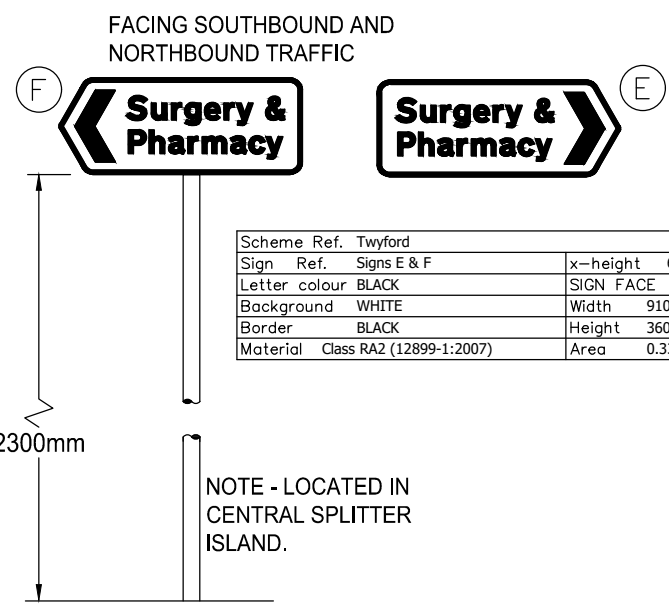

Scheme Ref. Twyford		
Sign Ref.	Signs E & F	x-height 62.5
Letter colour	BLACK	SIGN FACE
Background	WHITE	Width 910 mm
Border	BLACK	Height 360 mm
Material	Class RA2 (12899-1:2007)	Area 0.33 m <sup>2</sup>

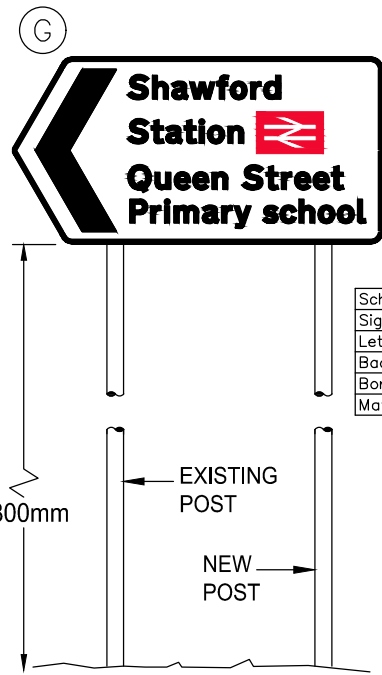

Scheme Ref. Twyford		
Sign Ref.	Sign G	x-height 62.5
Letter colour	BLACK	SIGN FACE
Background	WHITE	Width 1385 mm
Border	BLACK	Height 695 mm
Material	Class RA2 (12899-1:2007)	Area 0.96 m <sup>2</sup>

Scheme Ref. Twyford		
Sign Ref.	Sign H	x-height 62.5
Letter colour	BLACK	SIGN FACE
Background	WHITE	Width 1385 mm
Border	BLACK	Height 695 mm
Material	Class RA2 (12899-1:2007)	Area 0.96 m <sup>2</sup>

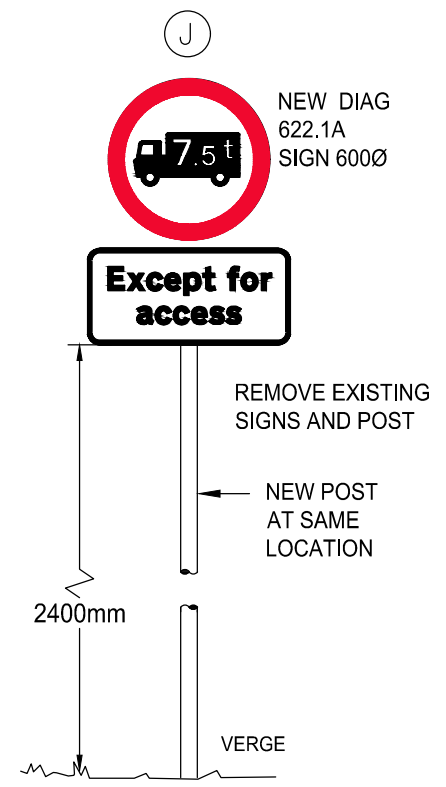
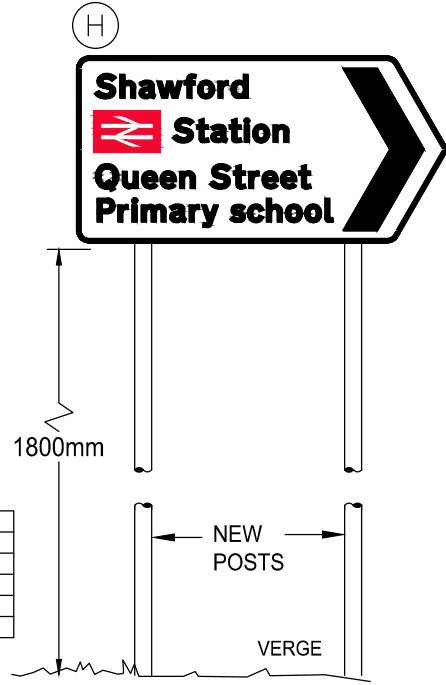

DO NOT SCALE FROM THIS DRAWING

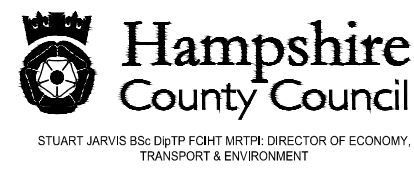

DESIGNER NB	SCHEME TWYFORD	DRAWING TITLE SIGN DESIGNS SHEET 1	
CAD LH		HCC CAD PLOT: 30/11/2022 13:18:38	
CHECKED NB	JOB No.	DATE OCT 22	SHEET NUMBER SE/NB/007
APPROVED	SCALE @ A3 NTS	DRAWING NUMBER	REV



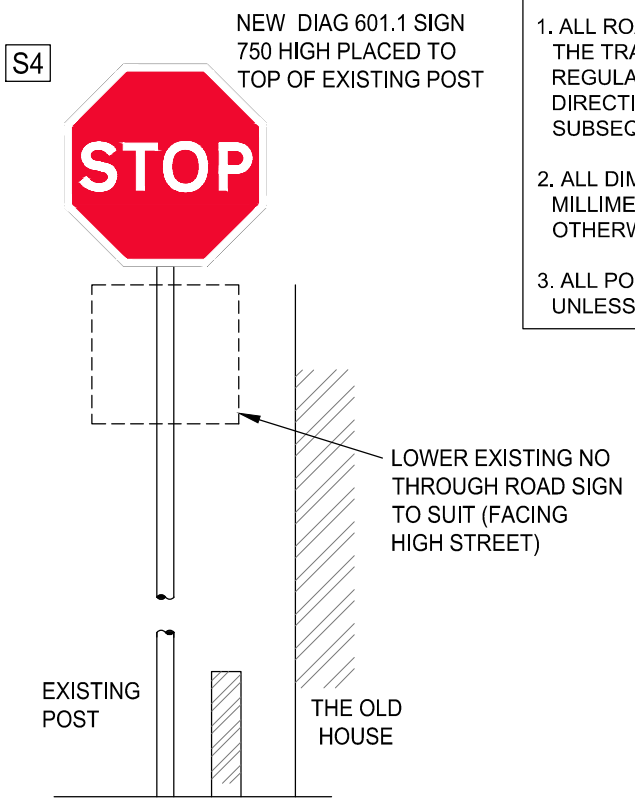
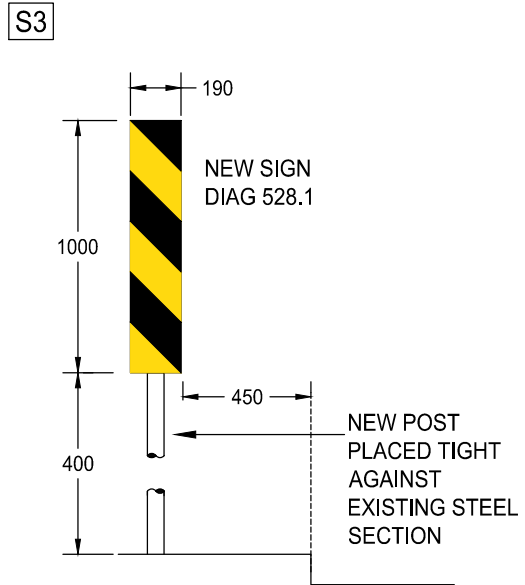
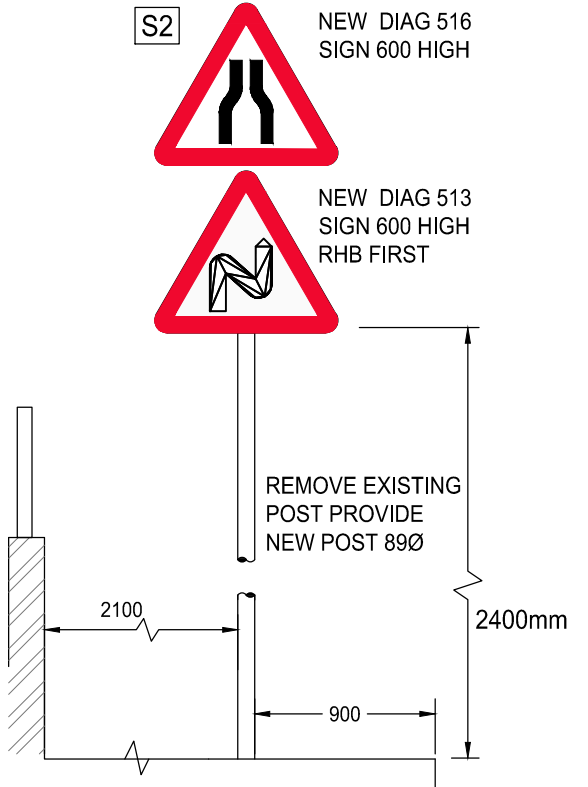
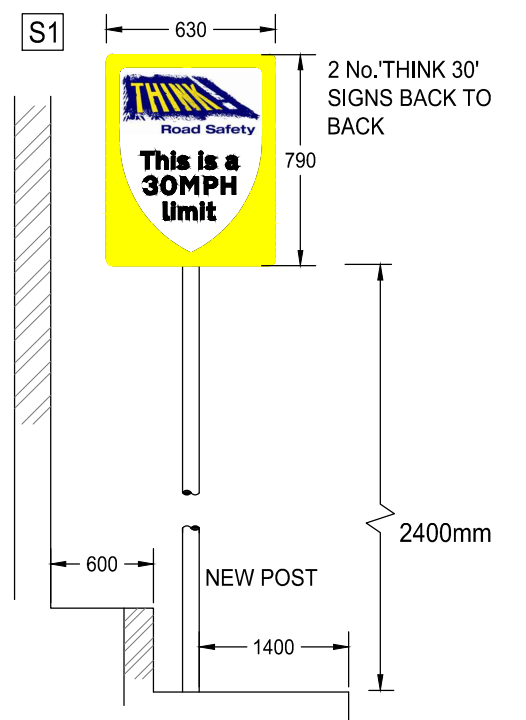

- NOTES**
1. ALL ROAD SIGNS SHALL BE TO THE TRAFFIC SIGNS REGULATIONS AND GENERAL DIRECTIONS 2016 AND ALL SUBSEQUENT AMENDMENTS.
  2. ALL DIMENSIONS IN MILLIMETERS UNLESS STATED OTHERWISE.
  3. ALL POSTS TO BE 76mmØ UNLESS STATED OTHERWISE

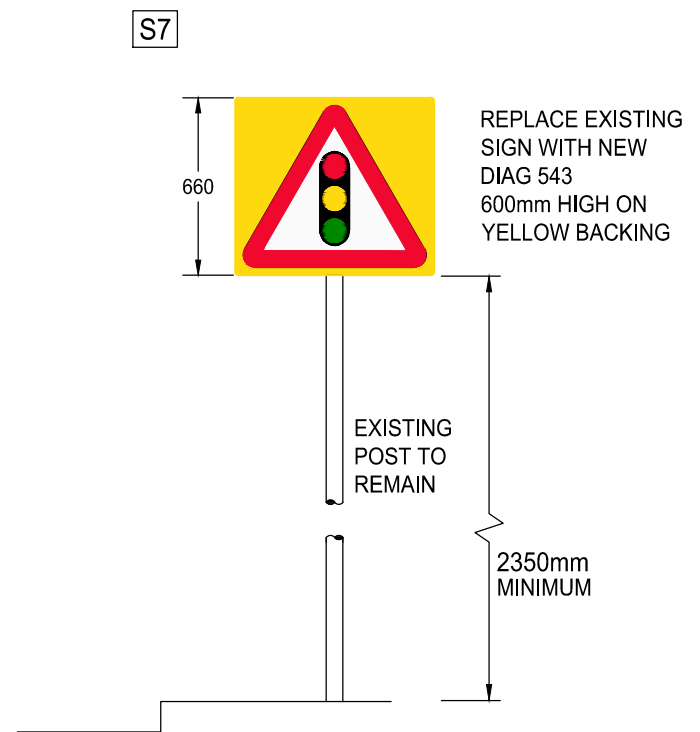
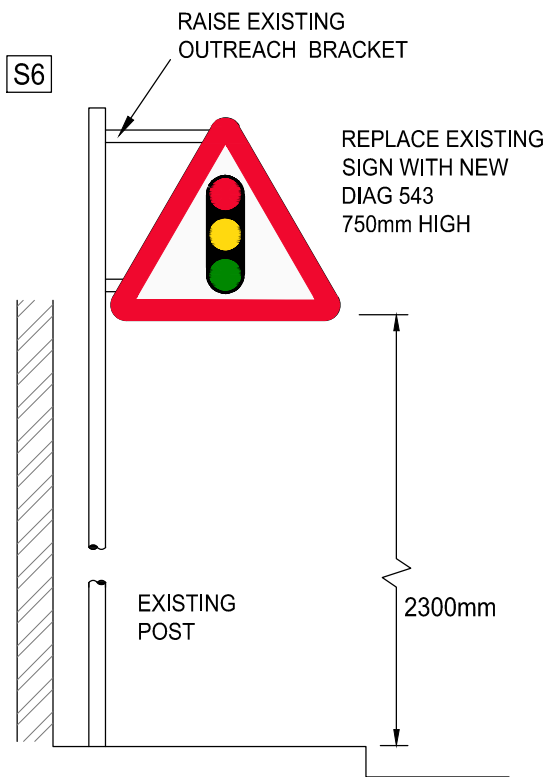
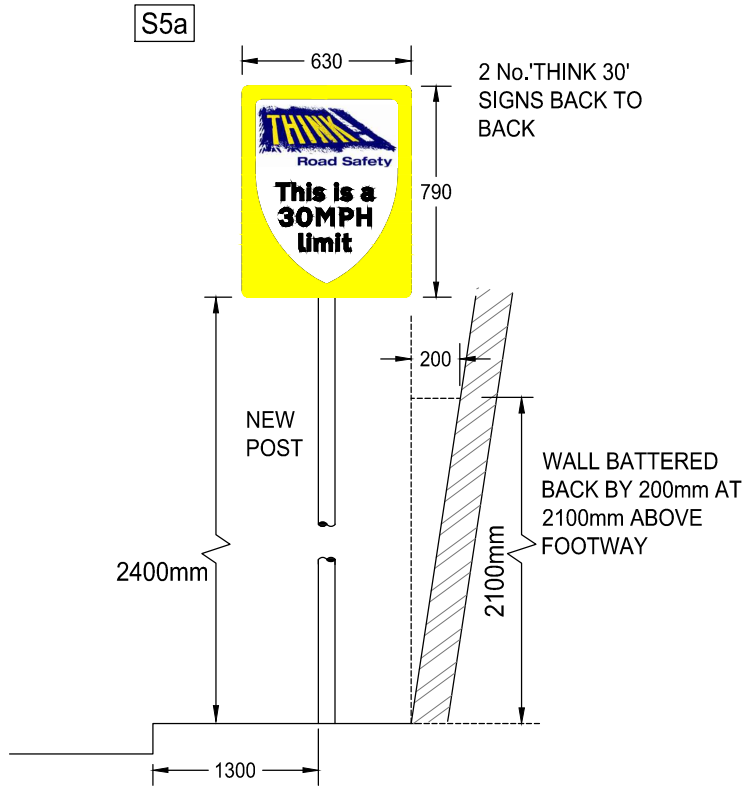
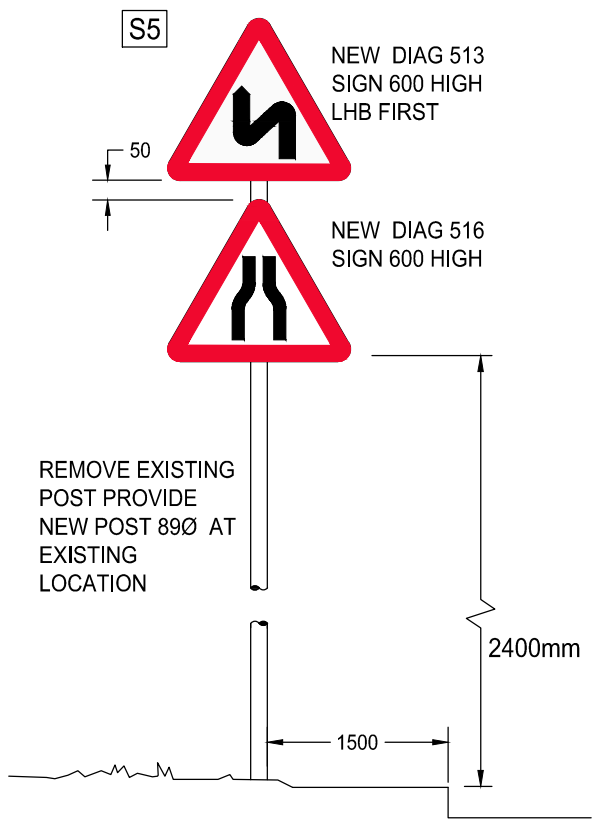

DO NOT SCALE FROM THIS DRAWING

**Hampshire  
County Council**

STUART JARVIS BSc DipTP FCIHT MRTPI, DIRECTOR OF ECONOMY,  
TRANSPORT & ENVIRONMENT

DESIGNER NB	SCHEME TWYFORD	DRAWING TITLE SIGN DESIGNS SHEET 2	
CAD LH		HCC CAD PLOT: 30/11/2022 13:18:43	
CHECKED NB	JOB No.	DATE OCT 22	SHEET NUMBER
APPROVED	SCALE @ A3 NTS	DRAWING NUMBER SE/NB/008	REV

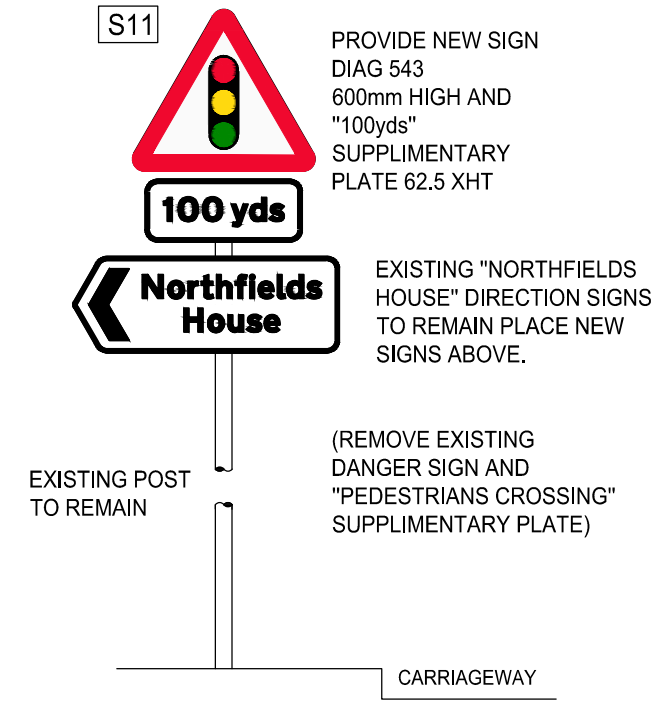
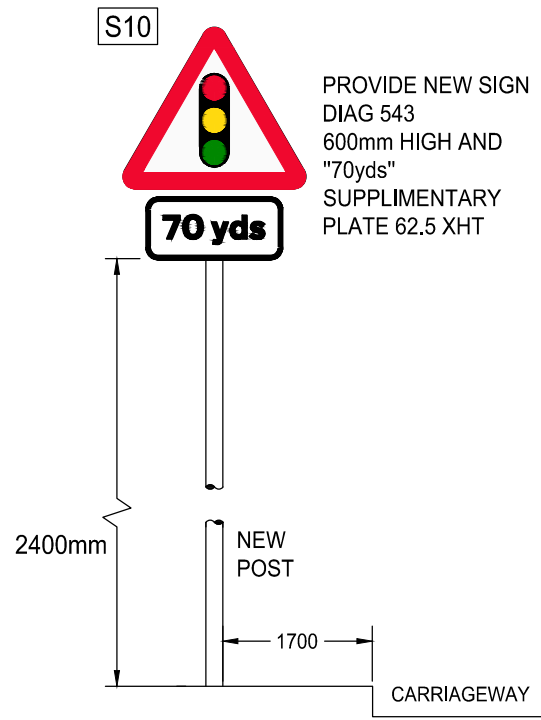
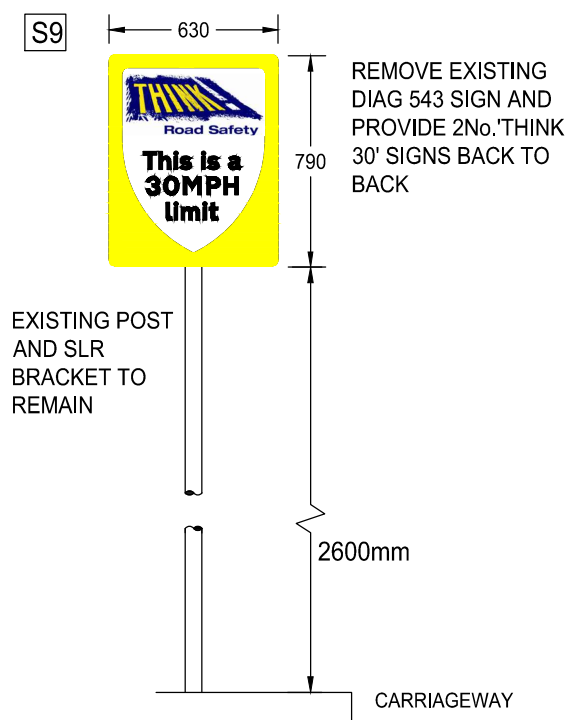
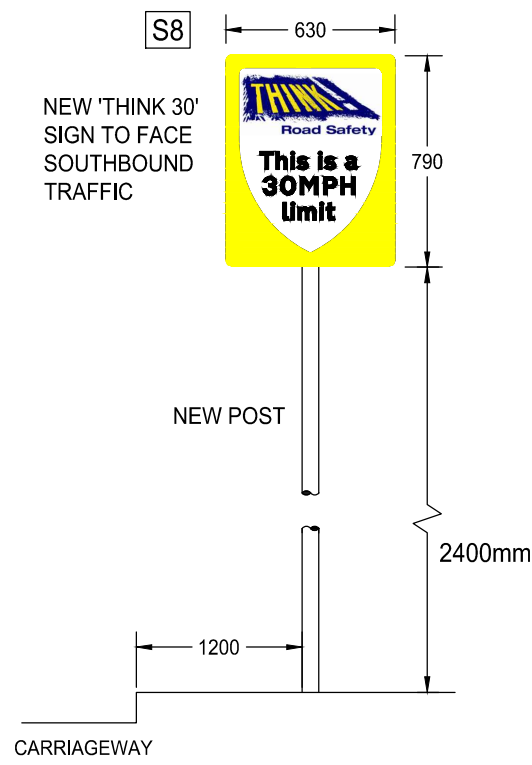

**NOTES**

1. ALL ROAD SIGNS SHALL BE TO THE TRAFFIC SIGNS REGULATIONS AND GENERAL DIRECTIONS 2016 AND ALL SUBSEQUENT AMENDMENTS.
2. ALL DIMENSIONS IN MILLIMETERS UNLESS STATED OTHERWISE.
3. ALL POSTS TO BE 76mmØ UNLESS STATED OTHERWISE

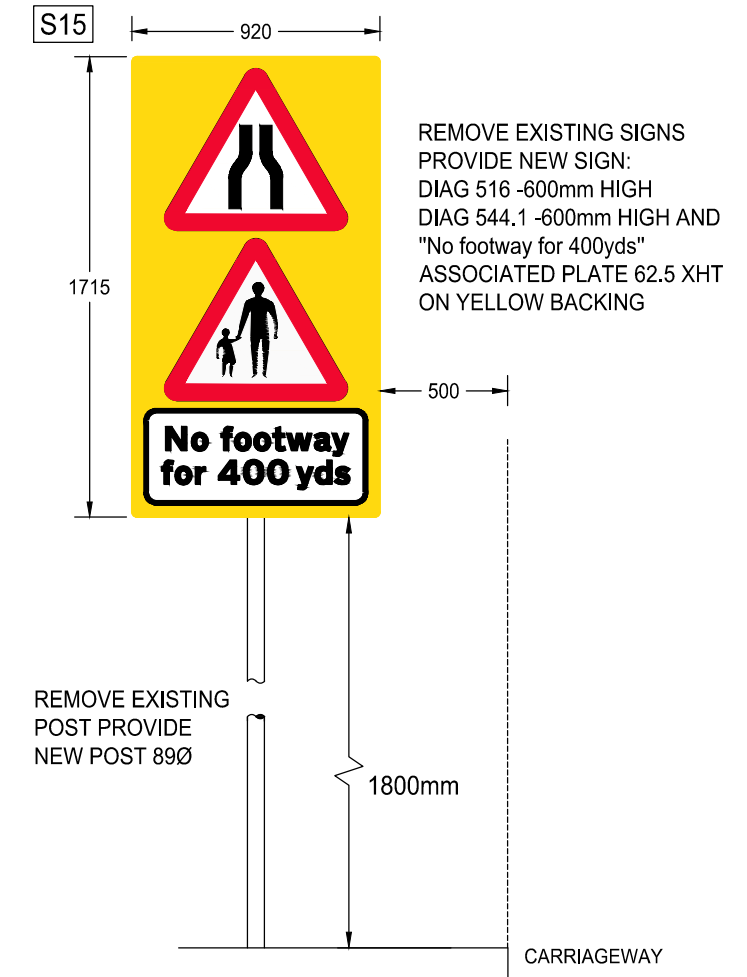
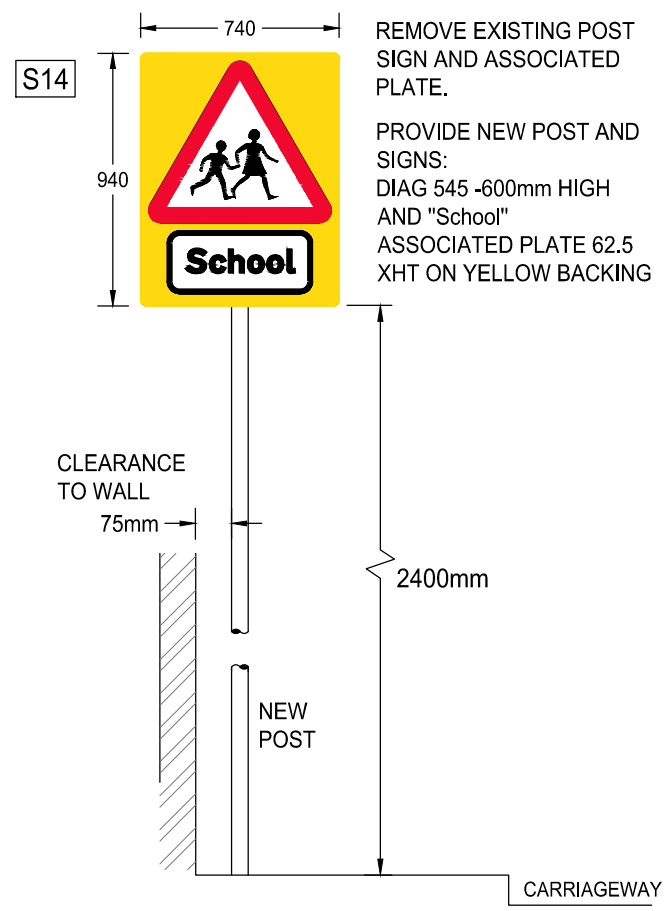
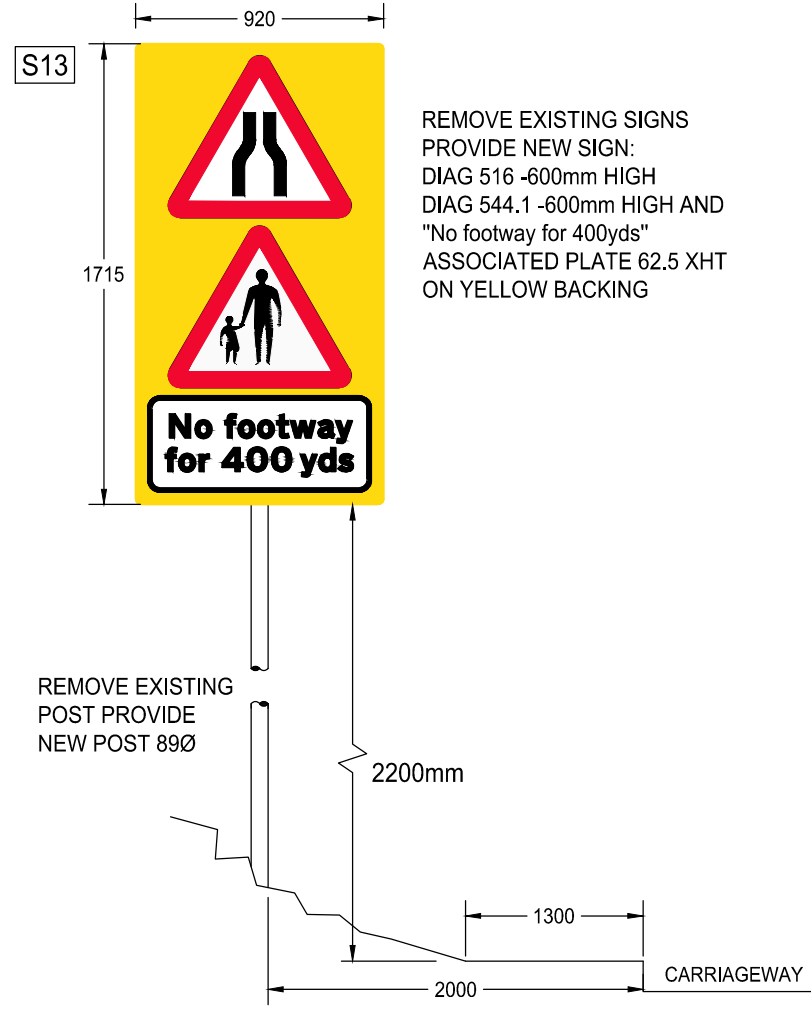
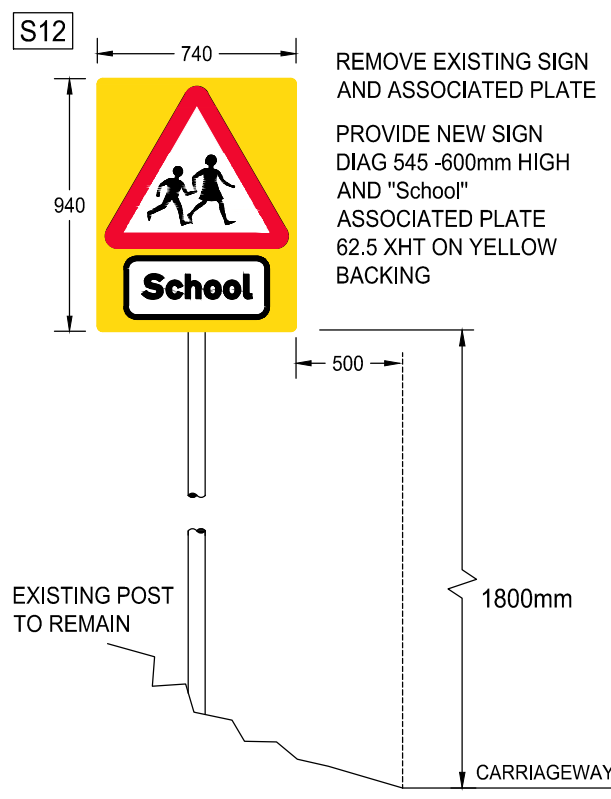

DO NOT SCALE FROM THIS DRAWING

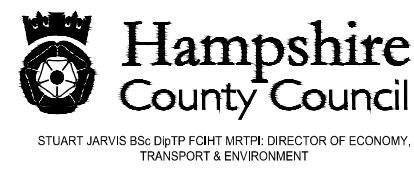

DESIGNER NB	SCHEME TWYFORD	DRAWING TITLE SIGN DESIGNS SHEET 3	
CAD LH		HCC CAD PLOT: 30/11/2022 13:18:49	
CHECKED NB	JOB No.	DATE OCT 22	DRAWING NUMBER SE/NB/009
APPROVED	SCALE @ A3 NTS	SHEET NUMBER	REV